



INSTRUCTION MANUAL



STEAM STATION

Model: Techne Pro 5000



Dear Customer

Congratulations on the purchase of your new USHA Steam Station Techne Pro 5000.

Designed with the most pertinent consumer needs in mind, the highly efficient Steam Station takes care of the tough creases of your clothes with its powerful steam output. It conditions your clothes and gives them a wrinkle free finish ensuring you get compliments the moment you step out of your home.

USHA Techne PRO5000 is a high-pressure steam station, equipped with its unique Programmed Temperature (P- Temp Mode) which allows the appliance to iron all types ironable fabric without adjusting the temperature of the iron.

Also the appliance gives you the option of selecting four different temperatures setting to handle different kinds of fabrics. Pressing the function button will take the appliance to P-temp mode followed by three other ironing temperatures.

USHA steam station have the capacity to hold up to 1000 ml water to give you uninterrupted high power steam for the good number of clothes you may want to iron over the weekend.

Its crystal clear electronic display is delightful for choosing the setting & navigating through various options with the help of a single touch Function button is smooth & easy.

Steam station as an alternative solution to ironing alleviates the fear of spoiling your treasured delicate clothes like business suits, wedding wear, designer wear, expensive sarees etc; ensuring their longevity.

Manufactured, using only the highest quality material and components, your USHA Steam Station is designed for years of years of trouble free performance.

Please read this Instruction Manual carefully before using and keep it cautiously after reading for future reference.

Best Wishes

IMPORTANT INSTRUCTIONS

For safety purpose you should read this instruction manual carefully before using the appliance for the first time and save this instruction manual for future reference.

The appliance is designed for domestic use and may only be operated in accordance with this instruction manual.

Always Handle with care and warn other users the potential hazards.

DO'S

1. Please use correct voltage: 220-240 V, 50 Hz AC. Please only connect the appliance to an earthed wall socket.
2. Unwind and straighten the power cord and Steam hose before use.
3. The appliance must be used and rested on a stable surface.
4. When placing the appliance on its stand, ensure that the surface on which the stand is placed is stable.
5. Power cord & Steam hose should not touch the soleplate.
6. The plug of the power cord must be removed from the socket-outlet before filling the water in the tank.
7. Keep the electrical appliances out of reach from Children or infirm persons. Do not let them to use the appliances without the supervision.
8. If the appliance is damaged, it must be repaired by the manufacturer or its service agent or qualified person in order to avoid a hazard.
9. Empty the water tank after use.
10. This appliance can be used by children aged from 8 years and above and persons with reduced physical, sensory or mental capabilities or lack of experience and knowledge if they have been given supervision or instruction concerning use of the appliance in a safe way and understand the hazards involved.
11. Keep the appliance out of reach from children less than 8 years of age while it is IN USE or cooling down.

DO NOT'S

1. Do not allow children to touch the appliance when ironing.
2. Do not allow children to play with the appliance.
3. Do not leave the appliance unattended when it is connected with a mains supply outlet.
4. Do not use an extension power cord set unless competent authority has approved it.
5. Do not add perfume, vinegar or other chemical liquids into the water tank.
6. Do not immerse the appliance into water or any other liquid.
7. Do not use the appliance when it is dropped, have visible sign of damage, performs abnormally or it is leaking.
8. Do not touch the rest surface of base unit during or just after ironing. It is HOT!

9. Do not roll the power cord or steam hose around the iron unit or base for storage until it has cooled down completely.
10. Do not attempt to open the cabinet or dismantle any parts from the appliance, there is no serviceable part inside.
11. The filling aperture must not be opened during use. Instructions for the safe refilling of the water tank is given separately in manual.
12. Do not allow children to perform cleaning and user maintenance when they are without supervision.
13. Do not touch the surfaces shown in Figure 2 and Figure 3 below, during or just after ironing. They are HOT!

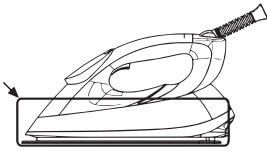

CAUTION: Hot Surface!

Figure 1: Left Side-Hot Surface

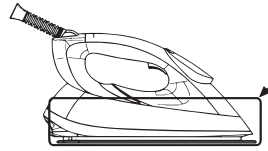

CAUTION: Hot Surface!

Figure 2: Right Side-Hot Surface

IDENTIFICATION OF PARTS

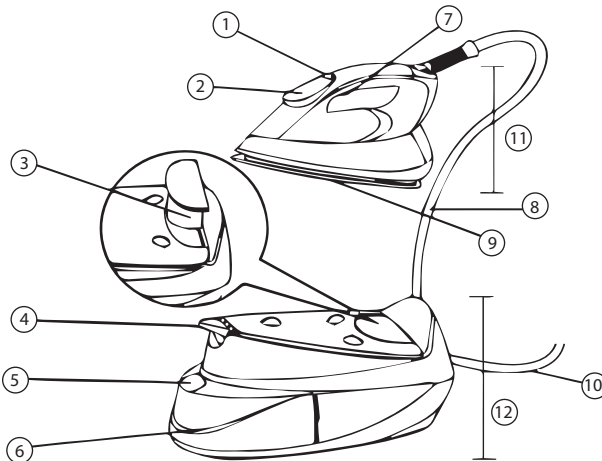

| | |
|-----|----------------------|
| 1. | Function Button |
| 2. | Control Panel |
| 3. | Anti-scale Cartridge |
| 4. | Carry Lock |
| 5. | Water Inlet Cover |
| 6. | Water Tank |
| 7. | Steam Trigger |
| 8. | Steam Hose |
| 9. | Soleplate |
| 10. | Power Cord |
| 11. | Iron Unit |
| 12. | Base |

TECHNICAL SPECIFICATION

RATED VOLTAGE : 240 V, 50 Hz AC
 RATED POWER : 2400 W
 WATER TANK CAPACITY : 1 Litre

Due to continuous efforts for product upgradation, specifications are subject to change without prior notice.

CONTROL PANEL:

| | | |
|--|--|--------------------------------|
| | | No Steam Indicator |
| | | Steam Level Indicator |
| | | Anti-scale Cartridge Indicator |
| | | Temperature Settings |
| | | P-Temp Mode Indicator |
| | | Auto Shut Off Indicator |
| | | Self-clean Indicator |
| | | ECO Indicator |

SETTING THE TEMPERATURE

The appliance has different temperature setting to handle different kinds of fabrics. Press the function button and the appliance will go to P-temp mode by default. If you want to switch to other ironing temperature, press the function key and the temperature will loop in a sequence of “P-temp mode” -> “Dot 1” -> “Dot 2” -> “Dot 3” -> “Max” -> “P-temp mode” as follow:

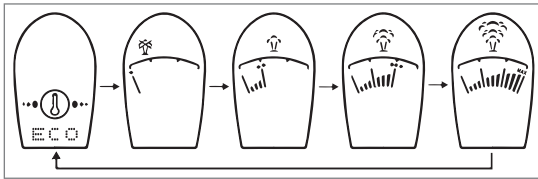

IMPORTANT: Before start ironing, read the garment labels and follow the manufacturer’s ironing instructions that are often shown by symbols:

If you are not sure about the fabric is made of, use the P-temp mode or begin the ironing at a low temperature and increase gradually.

PROGRAMMED TEMPERATURE (P-Temp Mode)

The appliance is equipped with Programmed Temperature which allows the appliance to iron all types ironable fabric without adjusting the temperature of the iron. It is the default mode of this appliance.

| | |
|--|--|
| | <p>Fabrics with these symbols are ironable, for example, Polyester, Silk, Viscose, Wool, Cotton and Linen.</p> |
| | <p>Fabrics with this symbol are not ironable, for example, Polypropylene, Elastane and Acrylic Fabric.</p> |

The ECO indicator will light up under P-temp mode and indicates that the energy is saved with sufficient steam flow to do ironing.

SAFETY AUTO SHUT-OFF FUNCTION

The safety auto shut-off function will operate automatically when the iron is left immobile or the function button/steam trigger not being pressed for 10 minutes.

1. The Auto Shut off Indicator will be flashing as shown in (Figure 3) to indicate the appliance is under safety auto shut off function.
2. To reactivate the iron, simply move it. The pilot light will light up to indicate that the iron is heating up, and it will go off when the iron is ready for use.

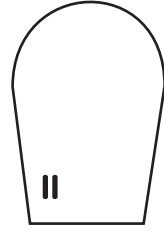

Figure 3

Note: The appliance is not switched off completely when it is in safety auto shut off function. Long press the function button and unplug the appliance to switch it off. The iron may take about 60 seconds to reach its previous soleplate temperature

ANTI-SCALE CARTRIDGE

This appliance has an anti-scale cartridge to prolong its lifespan. Normally, the cartridge can last for around 30L of water usage.

1. When the Anti-scale Cartridge Indicator lights up (Figure 4), it indicates the anti-scale cartridge needs to be changed. It is very important for you to change the cartridge before continue to do ironing.
2. Immerse a new anti-scale cartridge into water for 5 minutes (Figure 5) before first use for better performance.
3. Press to release the cartridge from the appliance and pull out the old cartridge from the appliance (Figure 6).
4. Insert the new anti-scale cartridge (Figure 7).

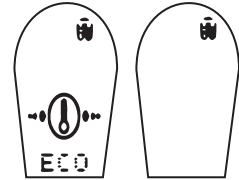

Figure 4

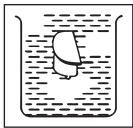

Figure 5



Figure 6



Figure 7

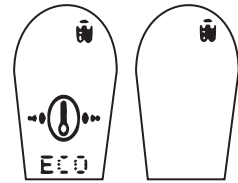

Figure 8

Note: If the anti-scale cartridge is not installed or installed improperly, the appliance will not be able to use and the Anti-scale Cartridge Indicator will be flashing (Figure 8).

SELF-CLEANING INDICATOR

This function removes the scales and minerals built up in the Steam Chamber. The appliance will remain in the best condition if this function is performed at least once a month or more regularly depending on the hardness of water used.

1. When the self-clean indicator lights up, it indicates that the appliance needs to undergo self-cleaning (Figure 9).

2. Fill the water tank to the max level (See "FILLING THE WATER TANK") and plug in the appliance.
3. Press the function button follow with the steam trigger and hold both buttons for 3 seconds. The appliance will then enter the self-cleaning mode.
4. Press the function key to proceed self-cleaning. Press the steam trigger to resume ironing. (Note: when self-cleaning is confirmed to proceed, it will not be able to terminate until the self-cleaning process is completed.)
5. Hold the iron about 15 centimeters above the sink in the ironing position. Loose material will come out through the steam holes of the iron together with water (Figure 10). The appliance will resume to the previous ironing setting when complete.
6. Ironing with a damped cloth to remove any deposits on the sole-plate. Remove any water stains that may have formed on the soleplate.
7. Long press the function button and unplug the appliance to switch it off.

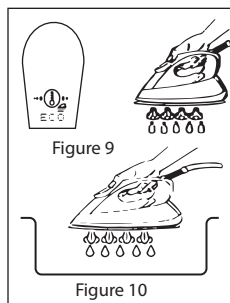

USING YOUR APPLIANCE

1. This appliance is designed to use normal tap water. Other liquid might damage the appliance.
2. Connect the appliance with a suitable mains supply outlet.
3. Start ironing after the icons on the display panel stop flashing which indicates the required temperature is reached and ready to use.
4. Always disconnect the appliance from the main after use.

BEFORE THE FIRST TIME USE

1. Remove any protective films or stickers on the appliance.
2. Unwind and straighten the power cord.
Note: When using the Steam Station for the first time, do not use it on your laundry. Some residue may remain inside the appliance. Begin the first time ironing with an old towel. Press the steam trigger to ensure the residues are completely released.

HINT FOR IRONING

1. Sort out the articles to be ironed according to the type of fabric. This will minimize the frequency of temperature adjustment for different garment.
2. Test ironing a small area on the backside or inside the garment if you are unsure about the type of fabric. Start with a low temperature and increase gradually.
3. Wait for 2 minutes before ironing the heat sensitive fabrics. Temperature adjustment needs certain time to reach the required level, no matter it is higher or lower.
4. Delicate fabrics such as silk, wool, velour, etc. are best ironed with an ironing cloth to prevent shine marks.

FILLING THE WATER TANK

1. Disconnect the power cord from electric outlet.
2. Pull out the water tank (Figure 11).
3. Open the Water Inlet Cover and fill the water into the water tank until the max level on the water tank (Figure 12).
4. Insert back the water tank in its place & click fix it properly before start using the appliance (Figure 13).

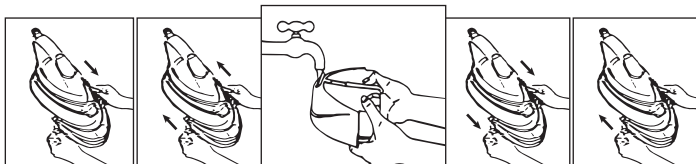

Figure 11

Figure 12

Figure 13

CARRY LOCK

The appliance is equipped with carry lock. You can carry the appliance with one hand by the handle of the iron unit when the iron is lock on the base (Figure 14). To release the iron unit from the base, turn the carry lock to unlock position (Figure 15).

Lock Position

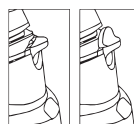

Figure 14

Unlock Position

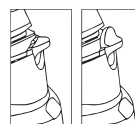





Figure 15

AUTO STEAM FUNCTION

The appliance is equipped with Auto Steam Function. The function will generate sufficient amount of steam for different temperature settings to achieve the optimal combination of temperature and steam for ironing.

TO DO IRONING

| | |
|--|--|
| <ol style="list-style-type: none"> 1. Press the function button to turn on the appliance and select your desired temperature to do ironing. | |
| <ol style="list-style-type: none"> 2. Depending on which temperature setting that you have selected, the corresponding temperature symbol will be flashing on display to indicate that the iron is heating up. When the iron is ready for use, the temperature symbol stop flashing and lights up continuously. | |

| | |
|--|---|
| <p>3. Steam ironing is available for all temperature setting except "Dot1". You can hold the steam trigger to generate steam for steam ironing. The respective steam indicator for "P-temp", "Dot 2", "Dot 3" and "Max" will flash indicates it is generating steam. Release the steam trigger to stop generating steam.</p> |  |
| <p>4. You can adjust the temperature setting of the appliance by pressing the function button. The corresponding temperature symbol will be flashing until the iron is ready for use.</p> |  |
| <p>5. After use, long press the function button for 2 seconds to turn off the appliance.</p> |  |
| <p>6. After every use, follow the instructions in "Draining the water". It is recommended to drain the water inside iron after use.</p> | |

VERTICAL STEAMING

You can also remove wrinkles on delicate garments in hanging position, hanging curtains, or other hanging fabrics:

1. Select your desired temperature setting with steam ironing available.
2. Hold the iron in vertical position 15 to 30 centimeters away from the garment (Figure 16).
3. Press the steam trigger.

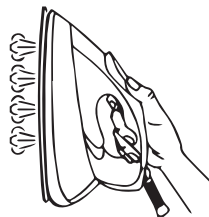

Figure 16

Warning: Do not apply steam on any clothes or fabrics that are being worn by human or pets. Temperature of steam is very high.

DRAINING THE WATER

Disconnect the iron from the mains supply outlet.

1. Pull out the water tank (Figure 17).
2. Open the Water Inlet Cover and drain water inside the water tank (Figure 18).
3. Insert back the water tank in its place (Figure 19).

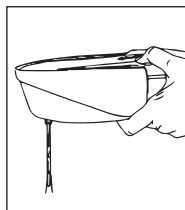

Figure 17

Figure 18

Figure 19

CLEANING AND MAINTENANCE

1. Disconnect the power cord from the mains supply outlet.
2. Use a dampened cloth or non-scratching cleaner to remove the deposits on the soleplate or the cabinets.
3. Never use sharp or rough objects to remove the deposit on the soleplate.
4. Never use any abrasive, vinegar or descaling agents to clean the iron.

STORING THE APPLIANCE

1. Make sure the water is already drained out from the water tank.
2. Place the iron unit on the base.
3. Turn the carry lock to the lock position.
4. You can carry the appliance with one hand by the handle of the iron unit when the iron is lock on the base.

TROUBLE-SHOOTING

If your steam generator does not work well, check the following points:

| Problem | Cause | Solution |
|---|---|--|
| The unit does not work | The unit does not heat up | Wait for heating up |
| | It is not plugged in | Plug in |
| | The anti-scale cartridge is not installed/ installed improperly | Install the scale cartridge properly |
| | Socket doesn't work | Plug in other good socket |
| No steam coming out when pressing the steam trigger | Water tank empty | Fill water tank |
| | The appliance is still heating up | Wait for heating up |
| | Steam ironing function is not working properly | Press the function button for a higher temperature setting |
| Sole-plate doesn't heat well | Incorrect Fabric setting | Press the function button for a higher temperature setting |
| Damage textile | Over heat | Follow the garment guide or test on the inside of the hem of the garment |
| Loud noise | First time use | It is normal |
| | Water tank empty | Fill water tank |

WARRANTY CARD

This appliance is warranted for 2 year against all manufacturing defects from the date of sale. In the event of any complaint, please contact Usha Care at Toll Free No. 1800 1033 111.

The warranty is valid only when:

- 1) The appliance has been installed, used and maintained in accordance with the instruction manual.
- 2) The warranty card and cash memo duly signed by the authorised dealer are presented with the complaint.
- 3) The appliance has not been opened or tampered with, by any unauthorised person. This warranty does not apply for:
 - 1) Damages due to chipping, peeling, plating and denting.
 - 2) Breakage or damage to components made out of Bakelite, Urea, ABS, SAN and such plastic materials, rubber parts and cord.
 - 3) Normal wear and tear of parts.
 - 4) Damage resulting from accidents, mishandling or negligence on part of the customer.

Liability for consequential loss or damages:

- 1) The Company will not be liable for any loss or damage arising/resulting from indirect or consequential loss or damages.
- 2) The Company aggregate liability in respect of all claims under the Warranty shall not exceed the original purchase price of the Product or, at Company's option, replacement of the Product with a like or similar Product.
- 3) The Company excludes all other warranties, conditions, terms, representations and undertakings whether express or implied.

Jurisdiction:

- 1) The courts at Delhi shall have exclusive jurisdiction to resolve any disputes between the parties arising under Terms and Conditions of Warranty.

S. NO: _____

CASH MEMO _____ DATE: _____

DEALER'S NAME AND ADDRESS: _____

OWNER'S NAME & ADDRESS: _____

USHA care®

— Toll free —

1800-1033-111

usha_care@ushainternational.com

USHA INTERNATIONAL LTD.

Plot No.15, Institutional Area, Sector 32, Gurugram - 122 001 (Haryana) Tel : +91-124-4583100, Fax : +91-124-4583200

E-mail : corporate@ushainternational.com Website : www.usha.com

Regd. Office : Surya Kiran Building, 19 Kasturba Gandhi Marg, New Delhi (India) Tel : +91 11 23318114 Fax : +91 11 23318118



SHRIRAM®

Fans • Sewing Machines • Home Appliances • Engines & Pumpsets • Electrical Motors & Pumps • Water Coolers & Dispensers
• Inverters • Cook Tops, Hobs & Hoods • Auto Components



© Registered Trademark and Copyright of USHA INTERNATIONAL LTD.



© Registered Trademark of USHA INTERNATIONAL LTD.

ISO 9001:2015
Certified Company